

www.huttonsgroup.com

THE **cristallo**

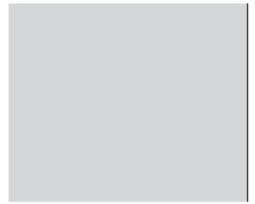



UNVEILING A NEW REALM OF POSSIBILITIES



Artist's Impression



www

integrated

grain



www.huttonsgroup.com  
DISCOVER LUXURY LIVING AT ITS FINEST

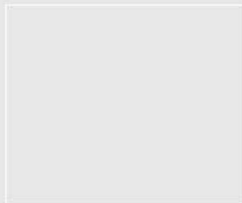
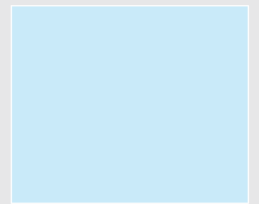
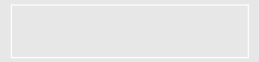





## WITNESS BEAUTY AND CHARM AT EVERY TURN

It's remarkably refreshing to be enthralled by the splendors of The Cristallo, indulging privacy away from hectic life. Lush greenery blissfully tucked away and enchantedly hidden within the gardens. Be enticed by the glistening swimming pool which rests the essence and enlivens the soul leaving you breathless with a zest for life! There is a fully equipped gym for the sporty and a pool deck to simply bask in the wonders of sheer relaxation. It is the charmed life of every person's dream place to call home.

[www.hullandson.com](http://www.hullandson.com)

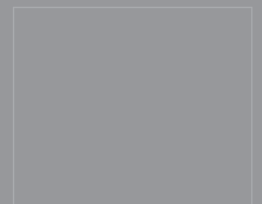





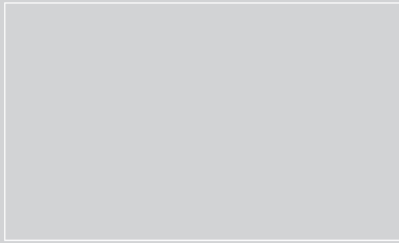

UNCOVER SECRETS WELL HIDDEN [www.huttonsgroup.com](http://www.huttonsgroup.com)

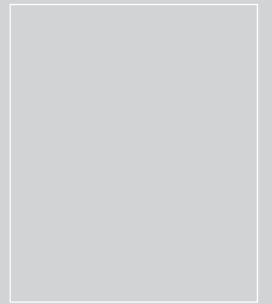
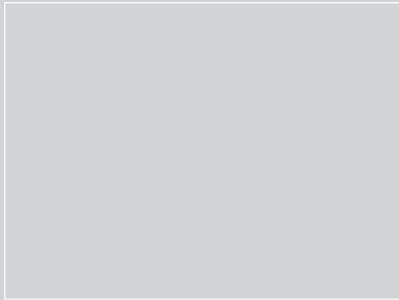
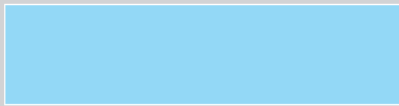



Relish the convenience of the Changi airport, an extensive array of shopping malls, MRT stations and established educational institutions in close proximity. Each and every turn brings upon an opportunity to discover the ease and comfort of the amenities close at hand. What better way to live than to have anything you might need within the closeness of home!







[www.buttonsgroup.com](http://www.buttonsgroup.com)

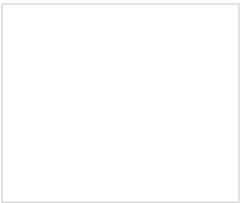

[www.huttonogroup.com](http://www.huttonogroup.com) INDULGE IN YOUR HEART'S EVERY DESIRE

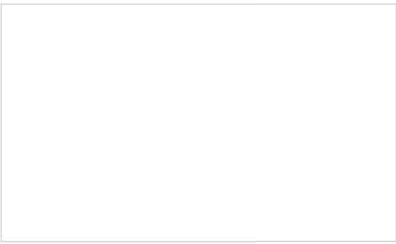
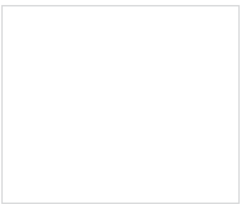



## IMMERSE YOURSELF IN UNPARALLELED RELAXATION

Indulge yourself in a lifestyle of affluence and sophistication. Simply take a cool dip into the stylish pool area and have drinks by the pool side with unbridled luxury. Relish each moment that your complete and fulfilling life promises. The open concept gymnasium promises a thorough workout to re-energise your body, mind and soul amidst a tranquil setting. Delight your senses in the blossoming foliage as you stroll and take in the beauty of The Crystallo, savoring what each special moment brings!



# FIRST STOREY COMMUNAL AREA PLAN

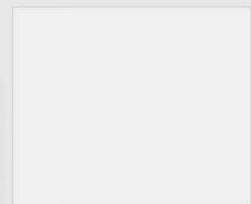
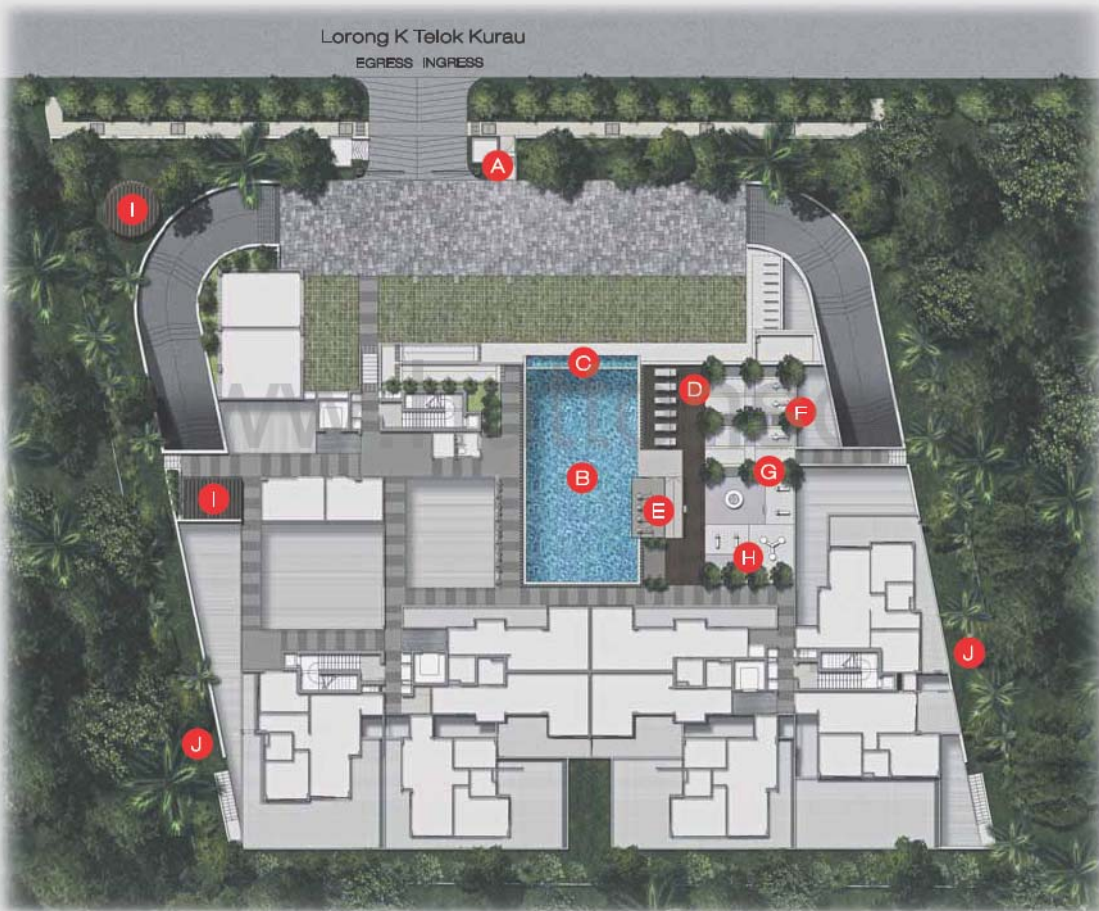

- A. Guard House
- B. Swimming Pool
- C. Reflective Pool
- D. Pool Deck
- E. Indoor Gym
- F. Outdoor Gym
- G. Leisure Sitting Lawn
- H. Children Play Area
- I. Pavillion
- J. Leisure Path

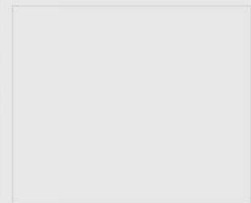
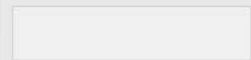



# ROOFTOP COMMUNAL AREA PLAN

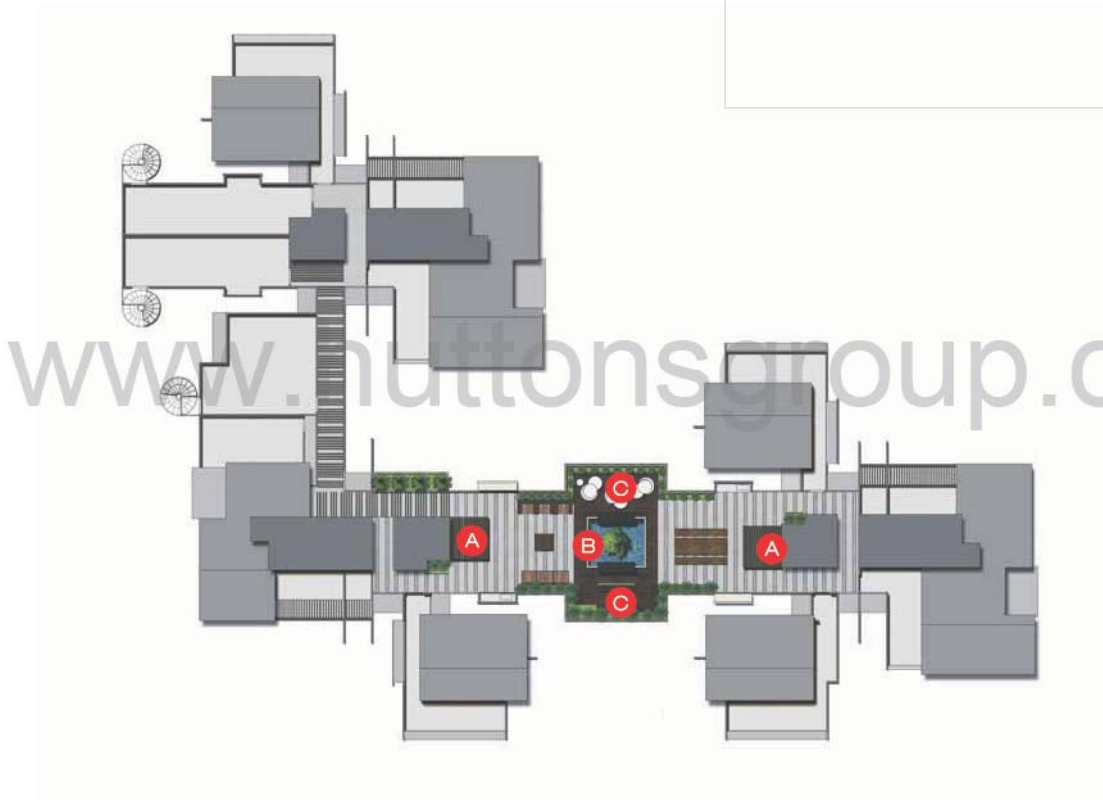

- A. BBQ Pavillion
- B. Reflective Pool
- C. Leisure Sitting Area

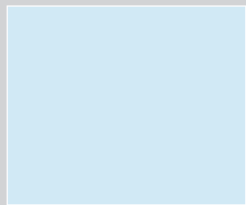

REDISCOVER A PLACE  
WHERE ELEGANCE MEETS COMFORT

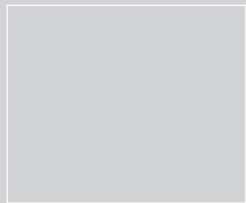
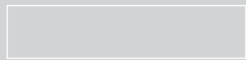

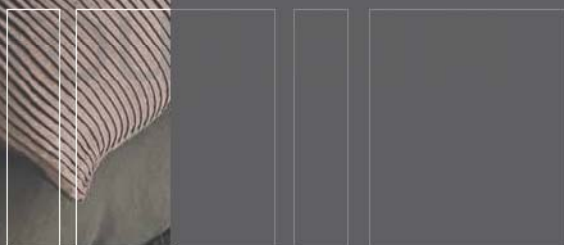



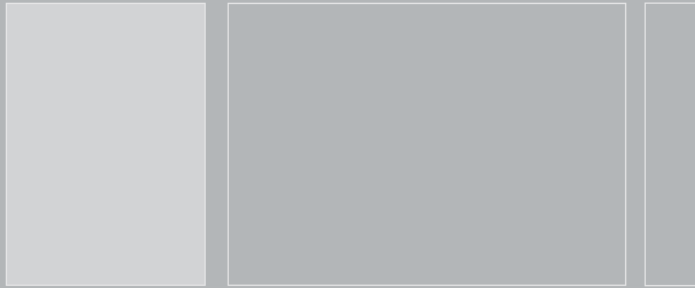

Reside in sheer designer quality layouts and finishes with the highest quality of sleek and chic. Each living space is meticulously designed with elegance and luxury in mind. The living room is a spacious open space with adjoining family rooms, bedrooms, fully equipped kitchen and well-facilitated bathrooms. Each individual space at home is fitted with the best of finishes and fittings for the well-heeled tastes in mind.

[www.huttonsgroup.com](http://www.huttonsgroup.com)

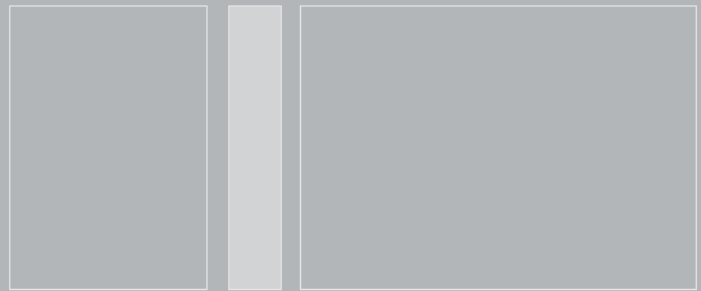





The Interior of The Cristallo is especially designed for its spacious bedrooms. Each bedroom is an enclave for a good night's rest and relaxation. A luxurious retreat after a long day is a feast to "wow" the senses. Its contemporary and innovative colours, design, feel and architecture take your breath away. With bathrooms that promise a luxurious and plush experience like no other, modern living is brought to a whole new level!



### TYPE A1 (Studio)

Unit #02-06 to #04-06  
Area 40 sq m / 431 sq ft  
(Inclusive of AC Ledge)



### TYPE A2 (Studio)

Unit #02-01 to #04-01  
Area 48 sq m / 517 sq ft  
(Inclusive of Balcony and AC Ledge)

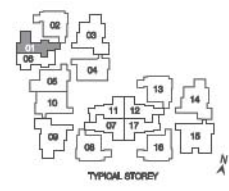
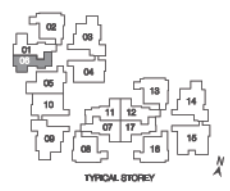
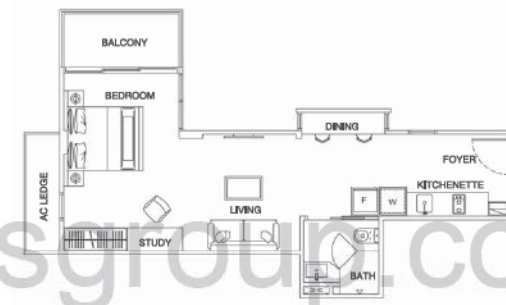

All plans are subjected to amendments as approved by the relevant authorities. Floor areas are approximate measurements and subject to final survey.



### TYPE A3 (Studio)

Unit #02-11 to #05-11  
Area 44 sq m / 474 sq ft  
(Inclusive of Balcony and AC Ledge)

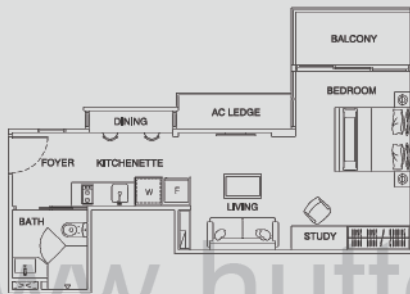

### TYPE A3a (Studio)

Unit #01-11  
Area 54 sq m / 581 sq ft  
(Inclusive of PES)

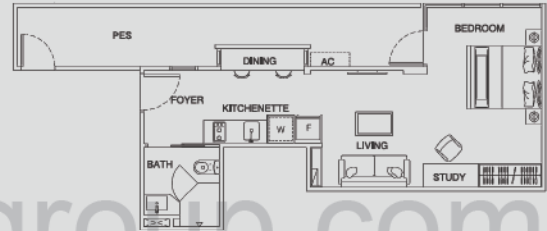

www.huttonsgroup.com

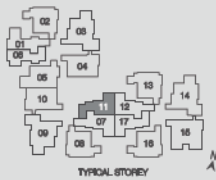

All plans are subjected to amendments as approved by the relevant authorities. Floor areas are approximate measurements and subject to final survey.

## TYPE A4 (Studio)

Unit #02-07 to #05-07  
 Area 48 sq m / 517 sq ft  
 (Inclusive of Balcony and AC Ledge)

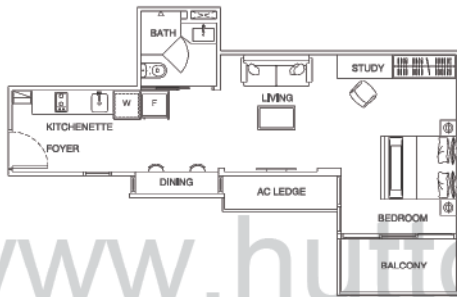

## TYPE A4a (Studio)

Unit #01-07  
 Area 56 sq m / 603 sq ft  
 (Inclusive of PES)

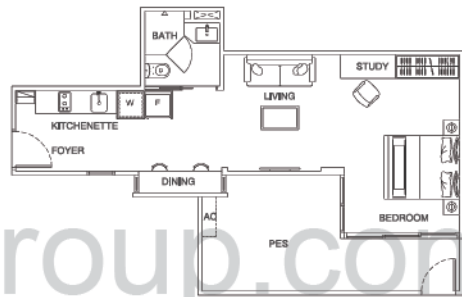

All plans are subjected to amendments as approved by the relevant authorities. Floor areas are approximate measurements and subject to final survey.

## TYPE A5 (Studio)

Unit #02-12 to #05-12  
 Area 48 sq m / 517 sq ft  
 (Inclusive of Balcony and AC Ledge)

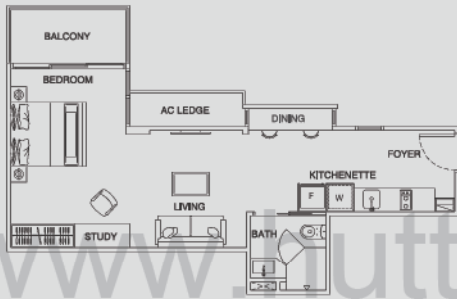

## TYPE A5a (Studio)

Unit #01-12  
 Area 57 sq m / 614 sq ft  
 (Inclusive of PES)

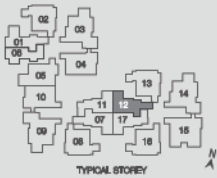
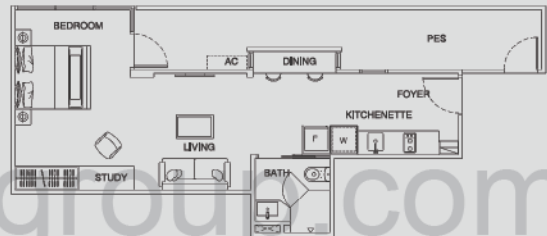

All plans are subjected to amendments as approved by the relevant authorities. Floor areas are approximate measurements and subject to final survey.

## TYPE A6 (Studio)

Unit #02-17 to #05-17  
 Area 44 sq m / 474 sq ft  
 (Inclusive of Balcony and AC Ledge)

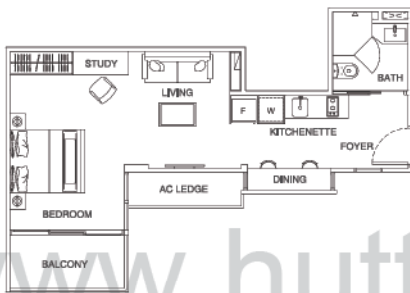

## TYPE A6a (Studio)

Unit #01-17  
 Area 52 sq m / 560 sq ft  
 (Inclusive of PES)



www.huttonsgroup.com



All plans are subjected to amendments as approved by the relevant authorities. Floor areas are approximate measurements and subject to final survey.

### TYPE B1 (2-Bedroom)

Unit #02-02 to #04-02 and #02-13 to 04-13  
Area 58 sq m / 624 sq ft  
(Inclusive of Balcony and AC Ledge)

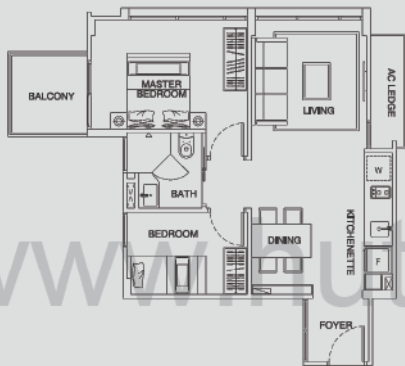

### TYPE B2 (2-Bedroom)

Unit #02-04 to #04-04 and #02-10 to #04-10  
Area 58 sq m / 624 sq ft  
(Inclusive of Balcony and AC Ledge)

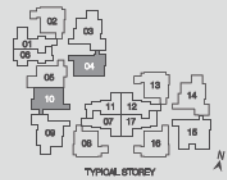
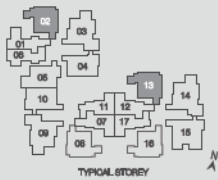
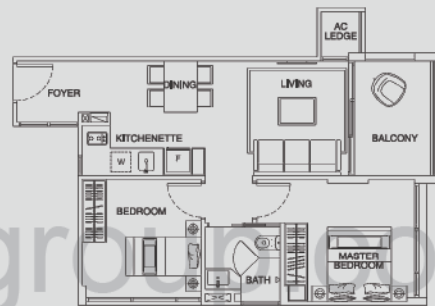

All plans are subjected to amendments as approved by the relevant authorities. Floor areas are approximate measurements and subject to final survey.

## TYPE B3 (2-Bedroom)

Unit #02-05 to #04-05  
 Area 60 sq m / 646 sq ft  
 (Inclusive of Balcony and AC Ledge)

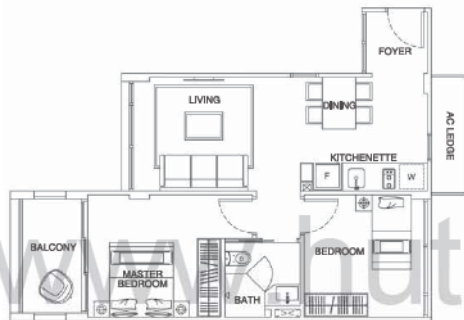

## TYPE B4 (2-Bedroom)

Unit #02-08 to #04-08  
 Area 58 sq m / 624 sq ft  
 (Inclusive of Balcony and AC Ledge)

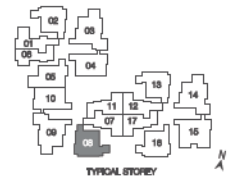

All plans are subjected to amendments as approved by the relevant authorities. Floor areas are approximate measurements and subject to final survey.

## TYPE B4a (2-Bedroom)

Unit #01-08  
 Area 101 sq m / 1,087 sq ft  
 (Inclusive of PES)

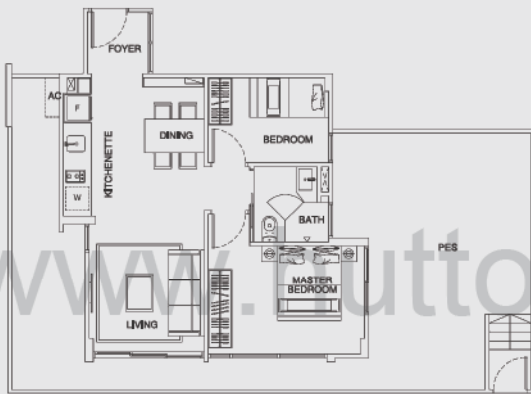

## TYPE B5 (2-Bedroom)

Unit #02-16 to #04-16  
 Area 58 sq m / 624 sq ft  
 (Inclusive of Balcony and AC Ledge)

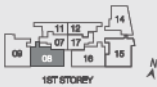
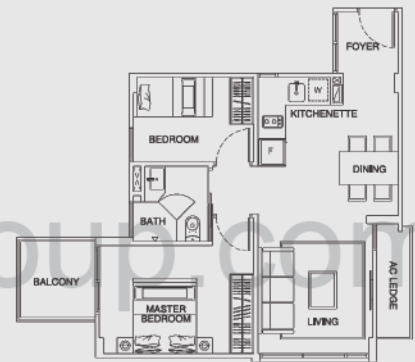

All plans are subjected to amendments as approved by the relevant authorities. Floor areas are approximate measurements and subject to final survey.

## TYPE B5a (2-Bedroom)

Unit #01-16  
 Area 101 sq m / 1,087 sq ft  
 (Inclusive of PES)

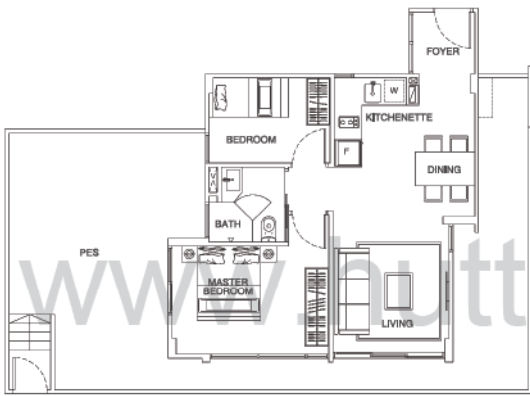

## TYPE B6 (2-Bedroom)

Unit #02-15 to #04-15  
 Area 74 sq m / 797 sq ft  
 (Inclusive of Balcony and AC Ledge)

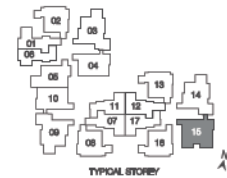
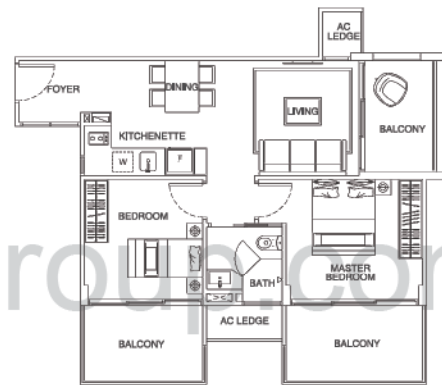

All plans are subjected to amendments as approved by the relevant authorities. Floor areas are approximate measurements and subject to final survey.



## TYPE B6a (2-Bedroom)

Unit #01-15  
 Area 115 sq m / 1,238 sq ft  
 (Inclusive of PES and AC Ledge)

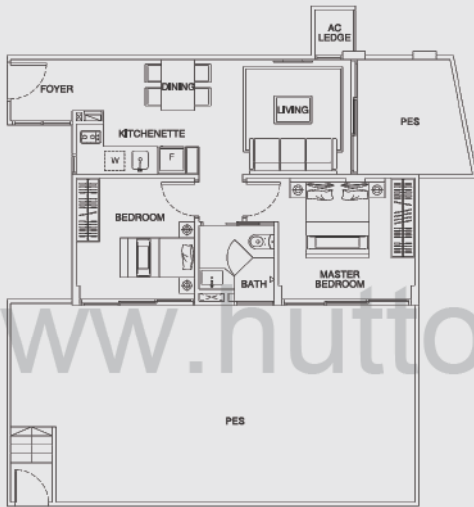

## TYPE C1 (2-Bedroom+Study)

Unit #02-03 to #04-03 and #02-14 to #04-14  
 Area 73 sq m / 786 sq ft  
 (Inclusive of Balcony and AC Ledge)

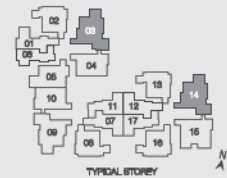
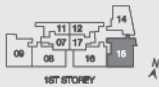
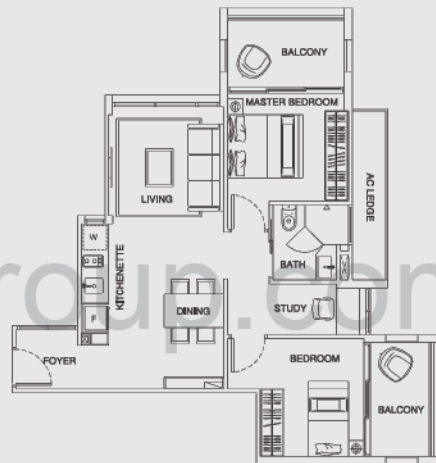

All plans are subjected to amendments as approved by the relevant authorities. Floor areas are approximate measurements and subject to final survey.

### TYPE C1a (2-Bedroom+Study)

Unit #01-14  
 Area 86 sq m / 926 sq ft  
 (Inclusive of PES)

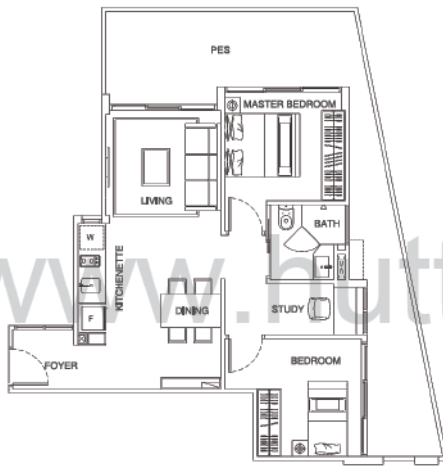

### TYPE C2 (2-Bedroom+Study)

Unit #02-09 to #04-09  
 Area 73 sq m / 786 sq ft  
 (Inclusive of Balcony and AC Ledge)

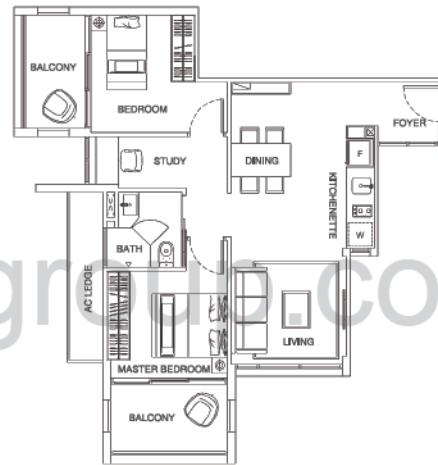

All plans are subjected to amendments as approved by the relevant authorities. Floor areas are approximate measurements and subject to final survey.

## TYPE C2a (2-Bedroom+Study)

Unit #01-09  
Area 119 sq m / 1,281 sq ft  
(Inclusive of PES)

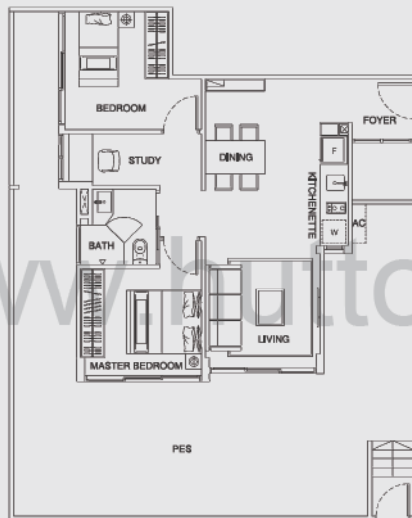

www.tiltonsgroup.com



All plans are subjected to amendments as approved by the relevant authorities. Floor areas are approximate measurements and subject to final survey.

## TYPE A1p (Studio Penthouse)

Unit #05-06  
 Area 74 sq m / 797 sq ft  
 (Inclusive of Roof Garden and AC Ledge)

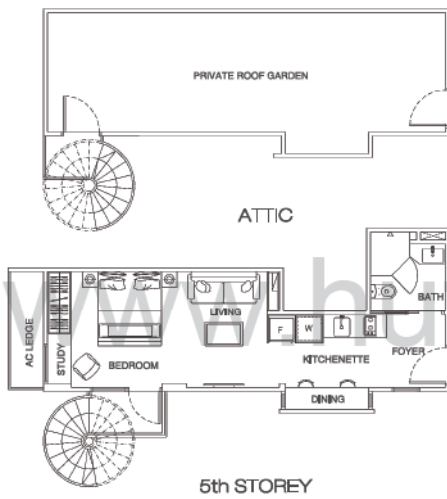

## TYPE A2p (Studio Penthouse)

Unit #05-01  
 Area 81 sq m / 872 sq ft  
 (Inclusive of Roof Garden and AC Ledge)

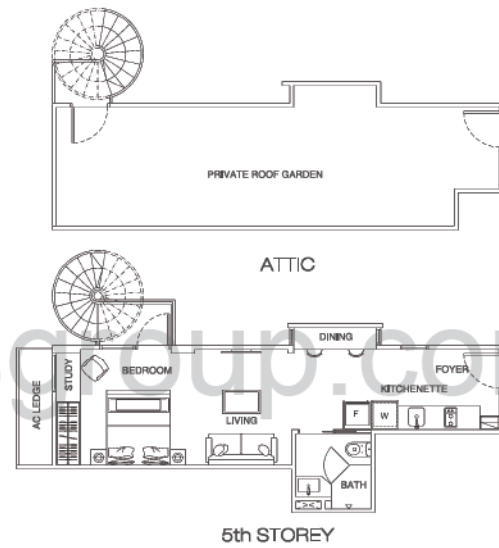

0 5 METRES

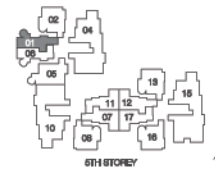

All plans are subjected to amendments as approved by the relevant authorities. Floor areas are approximate measurements and subject to final survey.

## TYPE B1p (2-Bedroom Penthouse)

Unit #05-02 and #05-13  
Area 93 sq m / 1,001 sq ft  
(Inclusive of Roof Garden and AC Ledge)

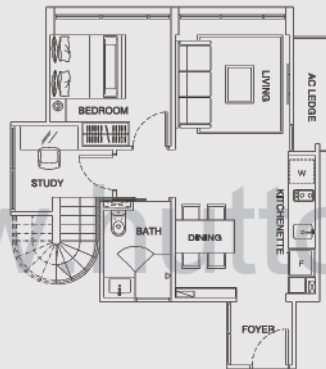

5th STOREY

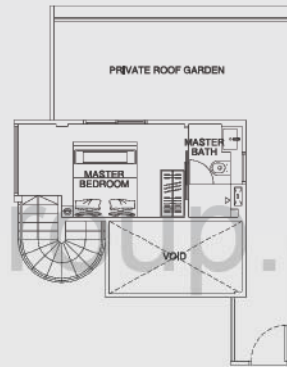

ATTIC



5TH STOREY



ATTIC

All plans are subjected to amendments as approved by the relevant authorities, Floor areas are approximate measurements and subject to final survey.

## TYPE B3p (2-Bedroom Penthouse)

Unit #05-05  
Area 101 sq m / 1,087 sq ft  
(Inclusive of Roof Garden and AC Ledge)

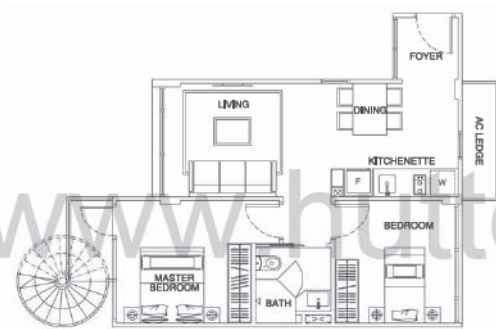

5th STOREY

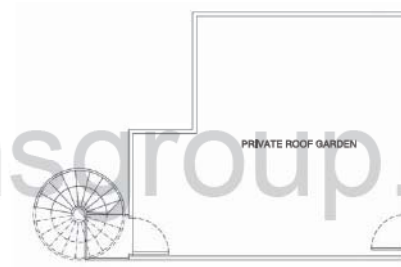

ATTIC

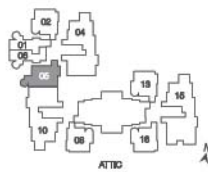

All plans are subjected to amendments as approved by the relevant authorities, Floor areas are approximate measurements and subject to final survey.

## TYPE B4p (2-Bedroom Penthouse)

Unit #05-08  
Area 91 sq m / 980 sq ft  
(Inclusive of Roof Terrace and AC Ledge)

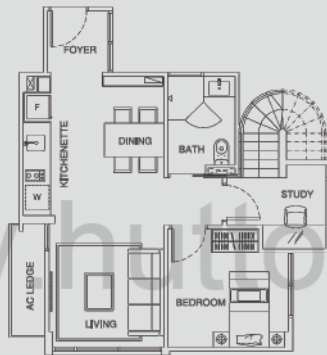

5th STOREY

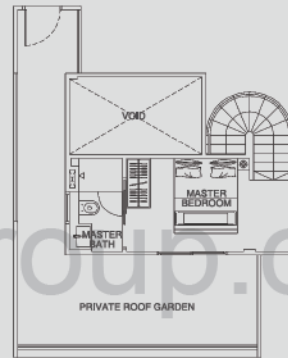

ATTIC



All plans are subjected to amendments as approved by the relevant authorities, Floor areas are approximate measurements and subject to final survey.

## TYPE B5p (2-Bedroom Penthouse)

Unit #05-16  
 Area 94 sq m / 1,012 sq ft  
 (Inclusive of Roof Garden and AC Ledge)

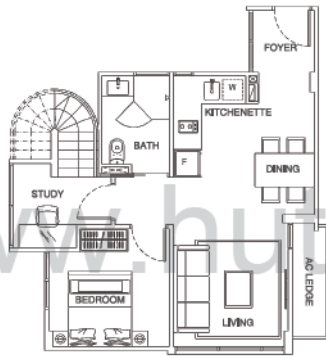

5th STOREY

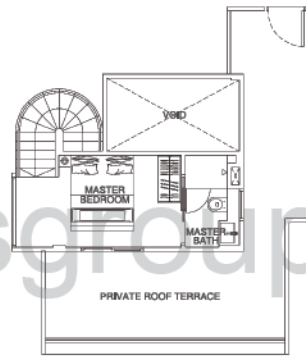

ATTIC



All plans are subjected to amendments as approved by the relevant authorities. Floor areas are approximate measurements and subject to final survey.



# TYPE C1p (3-Bedroom Penthouse)

Unit #05-04  
 Area 176 sq m / 1,894 sq ft  
 (Inclusive of Roof Garden, Balcony and AC Ledge)

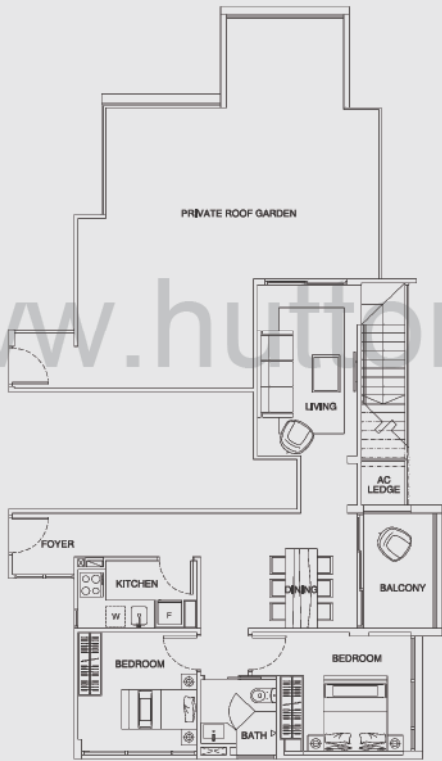
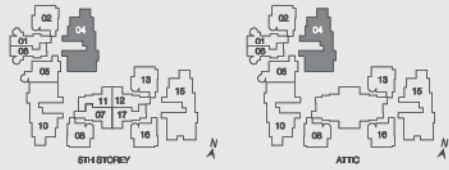

5th STOREY

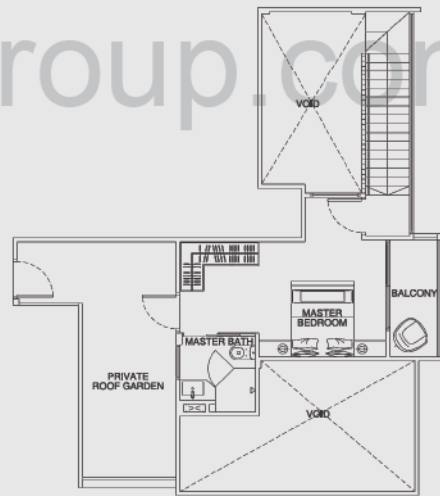

ATTIC

All plans are subjected to amendments as approved by the relevant authorities. Floor areas are approximate measurements and subject to final survey.

# TYPE C2p (3-Bedroom Penthouse)

Unit #05-10  
 Area 173 sq m / 1,862 sq ft  
 (Inclusive of Roof Garden, Balcony and AC Ledge)

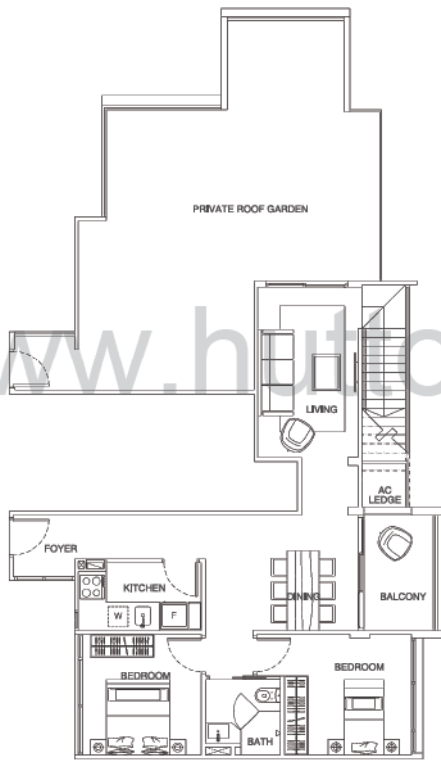

5th STOREY

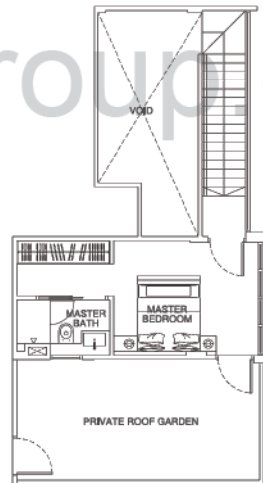

ATTIC



All plans are subjected to amendments as approved by the relevant authorities. Floor areas are approximate measurements and subject to final survey.

# TYPE C3p (3-Bedroom Penthouse)

Unit #05-15  
Area 191 sq m / 2,056 sq ft  
(Inclusive of Roof Garden, Balcony and AC Ledge)

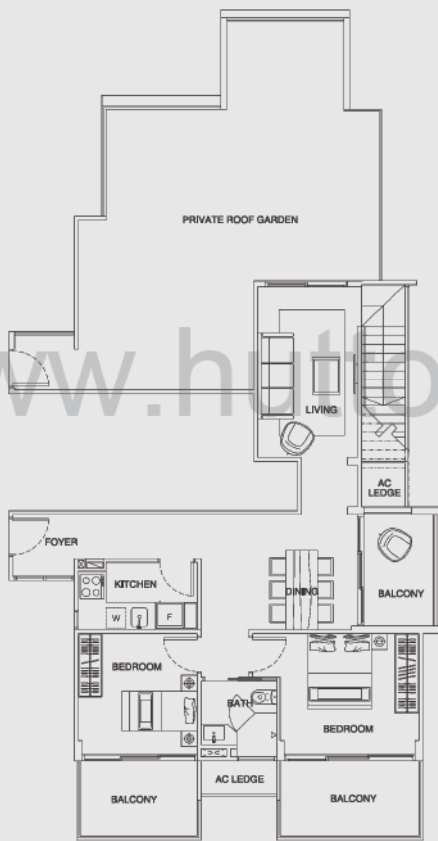

5th STOREY

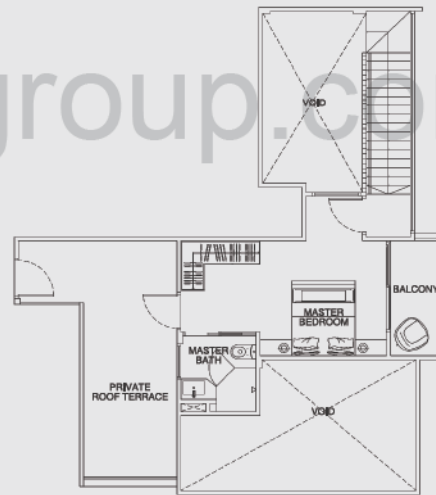

ATTIC



All plans are subjected to amendments as approved by the relevant authorities. Floor areas are approximate measurements and subject to final survey.

## TA CORPORATION LTD

We are currently known as TA Corporation Ltd after turning into a public listed company (formerly known as Tiong Aik Group of Companies). We have retained our reputation for our standard of excellence in developing premium homes and further built upon that, offering you the best.

Recognised for our high quality housing in Singapore, TA Corporation is a significant developer best known for our hallmark materials, stellar finishes and unwavering workmanship. Our team of acclaimed consultants from architects to engineers to landscape artists set the gold standard in providing lifestyle homes for your discerning tastes.

At TA Corporation, we bring comfort, luxury and elegance to your homes.



Starlight Suites



Parc Seabreeze



The Inspira



Coralls



Estlo



Leoniehill Residences